

## SCREW BOLTS FOR BOTTOM PLATE FIXING



FORTRESS Screw Bolts are a single piece heavy duty anchor, easy to install and removable. For use in any MPa concrete and timber joists.

Available in: Zinc plated, Zinc (Countersunk), Galvanised

Description	Hole Diameter (mm)	Embedment Dept (mm)	Fastens Material Up To (mm)	Available in*
6 X 30	6	25	5	Z CSK
6 X 50	6	25	25	ZP
6 X 75	6	25	50	ZP,
6 X 100	6	25	75	Z CSK
6.5 X 50	6	25	25	Z CSK
8 X 60	8	35	25	ZP
8 X 75	8	35	40	ZP
8 X 100	8	35	65	ZP, Z CSK
10 X 60	10	40	20	ZP
10 X 75	10	40	35	ZP
10 X 100	10	40	60	ZP
10 X 120	10	40	80	ZP, GAL
12 X 75	12	50	25	ZP
12 X 100	12	50	50	ZP, Z CSK, GAL
12 X 150	12	50	100	ZP, Z CSK, GAL
12 X 200	12	50	150	ZP
16 X 100	16	65	35	GAL
16 X 150	16	65	85	GAL

\*KEY: ZP = Zinc Z CSK = Zinc Counter sunk GAL = Galvanised

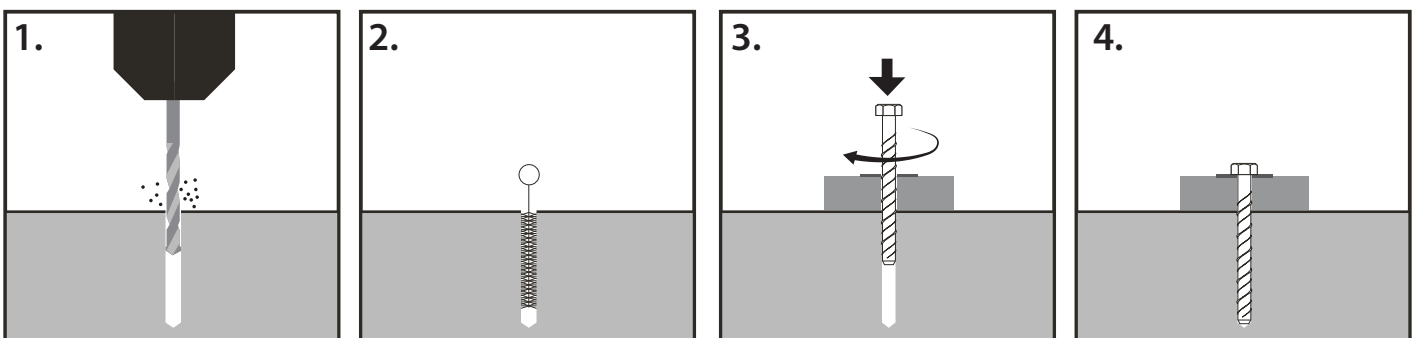

## SCREW BOLTS FOR BOTTOM PLATE FIXING



M10 x 120 and M12 x 150 Fortress Screw Bolts hold BRANZ appraisals for bottom plate fixing application.

Available in: Galvanised



To BRANZ appraisal no. 687 (2010)

Description	Hole Diameter (mm)	Embedment Dept (mm)	Fastens Material Up To (mm)	Tightening Torque (Nm)
10 X 120	10	40	80	45
12 X 150	12	50	100	45

Description	Characteristic Strength (kN)	Max bracing units per metre	Internal wall Spacing (mm)	External wall Spacing (mm)*	Min Edge distance (mm)
10 X 120	11	120 (6kN)	900	725	60
12 X 150	15	150 (7.5kN)	900	900	60

\*Formed Concrete Foundation

Installation Guide: Using correct diameter, drill into base material. Drilled hole must be at least 10mm greater than embedment depth. Clean the hole of dust. Insert the anchor through the fixture into the anchoring hole. Tighten until anchor is firm against the fixture.

