

SLEEVE ANCHORS

FORTRESS Sleeve Anchors are a torque controlled, fully sleeved expansion anchor for construction fixing into concrete and masonry.

Available in: Zinc plated, Galvanised, 316 Stainless Steel



Description	Hole Diameter (mm)	Embedment Dept (mm)	Fastens Material Up To (mm)	Available in*
6.5 X 20	6.5	18	2	ZP
6.5 X 25	6.5	20	5	ZP
6.5 X 36	6.5	30	6	ZP, Z CSK, 316
6.5 X 55	6.5	30	25	ZP, Z CSK, 316
6.5 X 75	6.5	30	45	ZP, Z CSK, 316
6.5 X 100	6.5	35	65	Z CSK
8 X 40	8	35	5	ZP, Z CSK, GAL, 316
8 X 60	8	35	25	Z CSK
8 X 65	8	35	30	ZP, Z CSK, GAL, 316
8 X 85	8	35	50	ZP, Z CSK
8 X 100	8	45	55	Z CSK
10 X 40	10	34	6	ZP
10 X 50	10	40	10	ZP, GAL, 316
10 X 60	10	40	20	ZP, GAL
10 X 75	10	40	35	ZP, Z CSK, GAL, 316
10 X 95	10	40	55	ZP, Z CSK, GAL, 316
10 X 100	10	40	60	Z CSK
10 X 120	10	40	80	Z CSK
10 X 125	10	40	85	Z CSK
12 X 60	12	50	10	ZP, Z CSK, GAL, 316
12 X 75	12	50	25	ZP, Z CSK, GAL, 316
12 X 100	12	50	50	ZP, Z CSK, GAL, 316
12 X 130	12	50	80	ZP, Z CSK, GAL
16 X 65	16	55	10	ZP, Z CSK, GAL
16 X 110	16	55	55	ZP
16 X 145	16	55	90	ZP
20 X 75	20	60	15	ZP
20 X 105	20	60	45	ZP
20 X 150	20	60	90	ZP

*KEY: ZP = Zinc Z CSK = Zinc Counter sunk GAL = Galvanised 316 = 316 Stainless Steel

Installation Guide: Using correct diameter, drill into base material.
 Drilled hole must be at least 12mm greater than embedment depth.
 Clean the hole of dust. Drive the anchor through the fixture into the anchoring hole until firmly placed against the fixture. Tighten 3 to 4 turns or by applying listed torque.

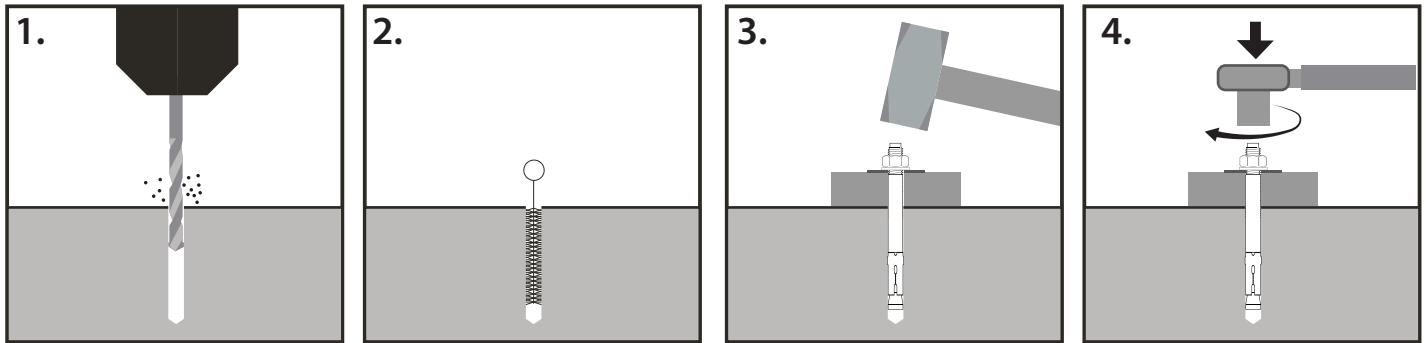

Description	Torque (Nm)	20 MPa Concrete		32 MPa Concrete		40 MPa Concrete	
		Tension kN	Shear kN	Tension kN	Shear kN	Tension kN	Shear kN
6.5 X 20	5	1.1	45	45	45	45	45
6.5 X 25	5	45	45	45	45	45	45
6.5 X 36	5	45	45	45	45	45	45
6.5 X 55	5	50	50	50	50	50	50
6.5 X 75	5	50	50	50	50	50	50
6.5 X 100	5	50	50	50	50	50	50
8 X 40	15	50	50	50	50	50	50
8 X 60	15	50	50	50	50	50	50
8 X 65	15	60	60	60	60	60	60
8 X 85	15	60	60	60	60	60	60
8 X 100	15	60	60	60	60	60	60
10 X 40	25	60	60	60	60	60	60
10 X 50	25	60	60	60	60	60	60
10 X 60	25	65	65	65	65	65	65
10 X 75	25	65	65	65	65	65	65
10 X 95	25	65	65	65	65	65	65
10 X 100	25	65	65	65	65	65	65
10 X 120	25	65	65	65	65	65	65
10 X 125	25	65	65	65	65	65	65
12 X 75	45	65	65	65	65	65	65
12 X 60	45	65	65	65	65	65	65
12 X 100	45	80	80	80	80	80	80
12 X 130	45	80	80	80	80	80	80
16 X 65	110	90	90	90	90	90	90
16 X 110	110	90	90	90	90	90	90
16 X 145	110	100	100	100	100	100	100
20 X 75	180	100	100	100	100	100	100
20 X 105	180	100	100	100	100	100	100
20 X 150	180	120	120	120	120	120	120